



Modular Cooking Range Line 700XP One Well Freestanding Gas Fryer 15 liter

ITEM # _____

MODEL # _____

NAME # _____

SIS # _____

AIA # _____



371070 (E7FRGDIGF0)

15-lt gas Fryer free standing with 1 "V" shape well (external burners), 1 basket and lid included

Short Form Specification

Item No. _____

To be installed on height adjustable feet in stainless steel. Two high efficiency 7 kW burners in stainless steel. Suitable for natural gas or LPG. Deep drawn V-shaped well. Oil drains through a tap into a container under the well. Exterior panels in stainless steel with Scotch Brite finish. One piece pressed work top in 1.5 mm thick stainless steel. Right-angled side edges to allow flush-fitting junction between units.

Main Features

- Unit to be mounted on 50mm height adjustable feet in stainless steel.
- Deep drawn V-Shaped well.
- Two high efficiency 7 kW burners in stainless steel with flame failure device attached to the outside of the well.
- Thermostatic regulation of oil temperature up to a maximum of 185 °C.
- Flame failure device on each burner.
- Overheat protection thermostat as standard on all units.
- Oil drains through a tap into a drainage container positioned under the well.
- All major compartments located in front of unit for ease of maintenance.
- Piezo spark ignition for added safety.
- Gas appliance supplied for use with natural or LPG gas, conversion jets supplied as standard.
- IPx4 water protection.
- Optional portable oil quality monitoring tool (code 9B8081) for efficient oil management.

Construction

- Interior of well with rounded corners for ease of cleaning.
- All exterior panels in Stainless Steel with Scotch Brite finishing.
- One piece pressed 1.5 mm work top in Stainless steel.
- Model has right-angled side edges to allow flush fitting joints between units, eliminating gaps and possible dirt traps.

Sustainability



- This model is compliant with Swiss Energy Efficiency Ordinance (730.02).

Included Accessories

- 1 of Door for open base cupboard PNC 206350
- 1 of Full size basket for 14 and 15lt free standing fryers PNC 921691

Optional Accessories

- Junction sealing kit PNC 206086
- Draught diverter, 120 mm diameter PNC 206126
- Matching ring for flue condenser, 120 mm diameter PNC 206127
- Flanged feet kit PNC 206136
- Frontal kicking strip for concrete installation, 400mm PNC 206147

APPROVAL: _____



Experience the Excellence
www.electroluxprofessional.com

- | | |
|---|--|
| <ul style="list-style-type: none"> • Frontal kicking strip for concrete installation, 800mm PNC 206148 <input type="checkbox"/> • Frontal kicking strip for concrete installation, 1000mm PNC 206150 <input type="checkbox"/> • Frontal kicking strip for concrete installation, 1200mm PNC 206151 <input type="checkbox"/> • Frontal kicking strip for concrete installation, 1600mm PNC 206152 <input type="checkbox"/> • Frontal kicking strip, 400mm (not for refr-freezer base) PNC 206175 <input type="checkbox"/> • Frontal kicking strip, 800mm (not for refr-freezer base) PNC 206176 <input type="checkbox"/> • Frontal kicking strip, 1000mm (not for refr-freezer base) PNC 206177 <input type="checkbox"/> • Frontal kicking strip, 1200mm (not for refr-freezer base) PNC 206178 <input type="checkbox"/> • Frontal kicking strip, 1600mm (not for refr-freezer base) PNC 206179 <input type="checkbox"/> • Kit 4 feet for concrete installation (not for 900 line free standing grill) PNC 206210 <input type="checkbox"/> • Sediment tray for 15lt fryers PNC 206235 <input type="checkbox"/> • Pair of side kicking strips PNC 206249 <input type="checkbox"/> • Pair of side kicking strips for concrete installation PNC 206265 <input type="checkbox"/> • Oil drain pipe for 15lt free standing fryer PNC 206301 <input type="checkbox"/> • Chimney upstand, 400mm PNC 206303 <input type="checkbox"/> • Right and left side handrails PNC 206307 <input type="checkbox"/> • Back handrail 800 mm PNC 206308 <input type="checkbox"/> • Flue condenser for 1/2 module, 120 mm diameter PNC 206310 <input type="checkbox"/> • Door for open base cupboard PNC 206350 <input type="checkbox"/> • Base support for feet or wheels - 400mm (700/900) PNC 206366 <input type="checkbox"/> • Base support for feet or wheels - 800mm (700/900) PNC 206367 <input type="checkbox"/> • Base support for feet or wheels - 1200mm (700/900) PNC 206368 <input type="checkbox"/> • Base support for feet or wheels - 1600mm (700/900) PNC 206369 <input type="checkbox"/> • Base support for feet or wheels - 2000mm (700/900) PNC 206370 <input type="checkbox"/> • Rear paneling - 600mm (700/900XP) PNC 206373 <input type="checkbox"/> • Rear paneling - 800mm (700/900) PNC 206374 <input type="checkbox"/> • Rear paneling - 1000mm (700/900) PNC 206375 <input type="checkbox"/> • Rear paneling - 1200mm (700/900) PNC 206376 <input type="checkbox"/> • Chimney grid net, 400mm (700XP/900) PNC 206400 <input type="checkbox"/> • Base support for feet or wheels - 600mm (700/900) PNC 206431 <input type="checkbox"/> • 2 side covering panels for free standing appliances PNC 216000 <input type="checkbox"/> • Full size basket for 14 and 15lt free standing fryers PNC 921691 <input type="checkbox"/> • 2 half size baskets for 14 and 15lt fryers PNC 921692 <input type="checkbox"/> | <ul style="list-style-type: none"> • Filter for fryer oil collection basin for 7lt, 14lt, 15lt free standing fryers PNC 921693 <input type="checkbox"/> • Unclogging rod for 15lt fryers drainage pipe PNC 921695 <input type="checkbox"/> • Deflector for floured products for 15lt fryers PNC 921696 <input type="checkbox"/> • Pressure regulator for gas units PNC 927225 <input type="checkbox"/> |
|---|--|

Front

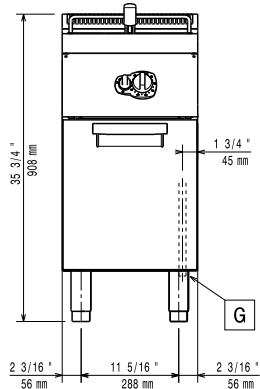

Side

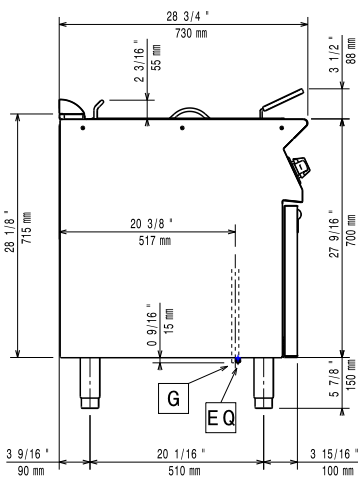

EQ = Equipotential screw
G = Gas connection

Top

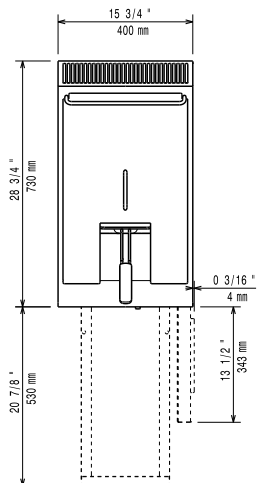

Gas

Gas Power:	14 kW
Standard gas delivery:	Natural Gas G20 (20mbar)
Gas Type Option:	LPG; Natural Gas
Gas Inlet:	1/2"

Key Information:

If appliance is set up or next to or against temperature sensitive furniture or similar, a safety gap of approximately 150 mm should be maintained or some form of heat insulation fitted.

Usable well dimensions (width):	240 mm
Usable well dimensions (height):	505 mm
Usable well dimensions (depth):	380 mm
Well capacity:	13 lt MIN; 15 lt MAX
Thermostat Range:	105 °C MIN; 185 °C MAX
Net weight:	55 kg
Shipping weight:	58 kg
Shipping height:	1140 mm
Shipping width:	460 mm
Shipping depth:	820 mm
Shipping volume:	0.43 m ³
Certification group:	N7FG